

# kome'o

## WATER TREATMENT UNIT

### Komeo water treatment unit



Please read the instructions in the manual carefully before removing the device from the box. Thank you for choosing a COMAP product.



To take advantage of technical and customer service, please register your product by returning the reply coupon from the warranty card, or register via [savcomapwt@comap.eu](mailto:savcomapwt@comap.eu)





# Contents



<b>I - Important recommendations</b>	<b>Page 4</b>
a) Important safety instructions and symbols	
b) Device-related safety instructions	
c) Guarantee (booklet provided in Appendix)	









<b>II - Description of Komeo</b>	<b>Page 9</b>
<b>III - Before installation</b>	<b>Page 10</b>
<b>IV - Installing Komeo</b>	<b>Page 14</b>
<b>V - Starting the machine</b>	<b>Page 17</b>
<b>VI - Description of the touch screen</b>	<b>Page 18</b>
a) Description of indicator lights	
b) Description of menus	
c) Downloading the remote control application	
d) Pairing the unit with the application	
<b>VII - Maintenance / Troubleshooting</b>	<b>Page 21</b>
a) Replacing the filters cartridge	
b) Replacing the UVc lamp	
c) Automatic prefilter cleaning	
d) Manual prefilter cleaning	
e) Replacing the fuse	
<b>VIII - Troubleshooting guide</b>	<b>Page 24</b>
a) Guide to errors	
b) What to do in case of a power cut	
c) Other maintenance operations	
d) What to do in case of a long absence	

# I - Important recommendations

## a) Important safety instructions and symbols

Before using this device, please read this guide carefully and keep it for future reference. Only use this device for its intended purpose and in accordance with the instructions given in the guide. This device must not be used by children under the age of 8 years or by persons of diminished physical, sensory or mental capacity or persons without any experience or knowledge unless they are properly supervised or if they have been given instructions concerning the safe use of the device and have understood the risks involved. Children must not play with the device. The cleaning and maintenance to be performed by the user must not be carried out by unsupervised children. The warnings and important safety instructions in this guide do not purport to cover every situation that is likely to occur. It is your responsibility to apply common sense and caution during installation, maintenance, and operation of the device.

## b) Device-related safety instructions

 WARNING	Risks or hazardous actions likely to lead to serious, or even fatal, injury.
 CAUTION	Inappropriate or hazardous use likely to cause slight injury or equipment damage.
	DO NOT attempt
	DO NOT disassemble
	DO NOT touch
	Apply the instructions to the letter.
	Disconnect the plug from the socket.

The purpose of these warning symbols is to help users avoid any risk of injury. They must be obeyed under all circumstances.

Read the "Safety instructions" section of this guide carefully, and keep the guide in a safe place so that you can refer to it in the future. A guarantee leaflet is also supplied with this guide. It gives details of the terms of the guarantee and the general safety instructions that apply to all of our products.



Ensure that the product is earthed and connected to a socket protected by a 30 mA residual current circuit breaker. Seek assistance from a professional if necessary.



Contact the technical support department for help (0033 (0)4-75-85-28-11)



Notes

## CE Notice

This product is compliant with the directives concerning Low Voltage (2006/95/EC, Electromagnetic Compatibility (2004/108/EC), limiting the use of certain dangerous substances in electrical and electronic equipment (RoHS), and Radio (1999/5/EC). The warnings and important safety instructions in this guide do not purport to cover every situation that is likely to occur. It is your responsibility to apply common sense and caution during installation, maintenance, and operation of the device.



Keep this user guide



**Dangerous leakage of UV-C radiation can occur if the device is used in a manner not intended or if its casing is damaged. Even at small doses, UV-C radiation can be hazardous to eyes and skin. Machines that are obviously damaged should not be put into operation. The device must be disconnected from the power supply before you replace the UV-C emitter.**



- If the power supply cable is damaged, it must be replaced by the manufacturer, its after-sales service department, or similarly qualified persons in order to prevent any danger.



- Disconnect the mains power supply cable from the device before removing the cover and before carrying out any maintenance.



- Do not modify the device.
- Keep the box for use as a mounting template for the device.



- Install the device on a cold water system (temperature between 5°C and 30°C).

- If the pressure in the cold water system exceeds 3 bar, a pressure reducing valve must be installed.

- Optimum operation of the device is achieved at flow rates below 2 m<sup>3</sup>/hour.

- Ensure that your device is located in a temperate location (temperature between 5°C and 35°C).

- The device needs to be connected to the electrical network. **Make sure it is installed near an electrical socket.** If not, have a socket installed.

- It is recommended that the device be placed within 2 metres of a waste water drain (optional).

- Connect the Komeo hydraulically according to DTU 60.1, 60.11.

- Never connect the power cable to a socket that has not been properly earthed, and ensure that it complies with local and national regulations.



WARNING



- **Never start up a device that shows any signs of damage. In case of doubt, call the after-sales service department.**



- Do not install the device in a location where it is exposed to direct sunlight or near a cooker, heater, or other devices.

- Any damage to the insulation of the electrical components is likely to cause electrocution or fire.

- Do not connect several devices to the same multi-socket.

- Do not connect the power supply plug to a badly installed wall socket.

- Do not use a cable whose sheath cracked or damaged at any point or at one of its ends.

- Do not pull the power cable or bend it too tightly, and do not place heavy objects on it. Do not tie it in a knot.

- Do not use aerosols near the device.

- Do not install this device in a location where gas leaks are likely to occur.



WARNING



WARNING



WARNING



- In case of a leak in the device, disconnect Komeo from the electrical network.

- This device must be earthed. To earth the device, do not connect it to a gas pipe, a plastic water pipe, or a telephone line. To do so could cause a risk of electric shock, electrocution, or fire.

- A shut-off valve and a standardised non-return valve must be installed upstream and downstream from the device. For proper WiFi operation, it is preferable to place Komeo in an area covered by your wireless router. If not, add a WiFi relay.



CAUTION





- Secure the device to the wall on a solid surface able to support 25 kg on four mounting points. The wall plugs provided are intended for use in materials such as concrete. For other types of material, use appropriate mounting hardware.



- **Do not install this device near a heat source or any flammable material.**
- **Do not install this device in a damp, oily, or dusty environment, or in a location where it is directly exposed to sunlight or water. Failure to apply this recommendation could cause electrocution or fire.**



- It is recommended that you call on a qualified technician or a repair company to install or repair the device or to update the software via the USB key. Failure to apply this recommendation could cause a risk of electric shock, fire, injury, or malfunction of the device.



- Do not touch the device's power plug if your hands are wet.



- The device must be earthed and connected via a standardised 230-Vac/16-A Phase/Neutral + Earth connector and protected by a 30-mA circuit breaker. Failure to apply this recommendation would lead to a risk of electrocution or injury.



- The fuse must be replaced by a qualified technician or repair company.



- If the power cable is damaged, immediately ask the manufacturer or certified repair technician to replace it.



- Insert the power supply plug to that the cable hangs down.



- **If the power cable is plugged in upside down, the cable could break, causing a fire or electrocution.**



- Do not climb onto the machine. Do not place any object (such as laundry, lighted candles, lighted cigarettes, metallic objects, etc.) on the machine.
- Do not place any container of water or filter bowl on the machine.
- **Do not attempt to look at the UVc lamp when it is switched on. This could cause irreversible damage to the retina and skin.**



- **Do not touch the UVc lamp with bare hands.**



- **In case of traces of dust or water leakage in the device, disconnect it and contact COMAP after-sales service. Shut off the water supply and switch the device to Bypass Mode (shunting the water circuit).**



- When commissioning the device, start by supplying it with water and check that there is no leakage in the device or the installation before connecting it to the electricity supply.



- **In the event of an extended absence of power supply, whether deliberate or not, disconnect the power cable, remove the protective cover, and set the battery unit switch to OFF. Apply these steps in reverse when normal power is restored.**



- If the machine is releasing a chemical odour or smoke, disconnect it immediately and contact COMAP after-sales service.



- Modifications can lead to injury and/or property damage. Modifications applied to this device by a third party are not covered by the COMAP service guarantee. COMAP accepts no liability in the event of safety issues or damage resulting from modifications made by a third party.

- Do not apply violent shocks or excessive force to the device or in

the quartz enclosure (glass tube) housing the UVC lamp. This could lead to cracking or breakage of the glass tube, bringing the lamp into contact with water from the circuit. This could lead to injury or electrocution.



- Be aware of the working life of consumables and replace them in strict accordance with the instruction manual. Never perform maintenance on the device with the power cable plugged in. The battery unit takes over to display the maintenance



- procedures on the touch screen. Never plug the power cable into the socket until the cover is closed.
- **Do not attempt to repair, disassemble, or modify the device yourself.**
- **This instruction manual is a guide to installing the Komeo water treatment unit. The illustrations it contains are not contractual.**

## **Technical characteristics:**

### **Electrical functions:**

- Anti-scaling by electrical field, with two treatment ratings. Rimeau technology Atex CSTBat N° 575 – 05/1995.
- Stainless UVc treatment chamber. 25-watt UVc lamp.
- Drinking water standard: Not less than 25 mj/cm<sup>2</sup>, in accordance with French Health directive in the circular of 19/01/1987 (achieved with a max. instantaneous flow in the water system of 1.5 m<sup>3</sup>/h).
- Electricity consumption slaved to water utilisation by an integral flow sensor (automatic standby function).
- 3.5" touch screen. Resolution 320 x 240 pixels
- 2.4-GHz single-band WiFi card. IEEE 802.11b/g/n.
- Motorised valve for prefilter inlet and outlet.
- Pressure sensors and flow meter.
- Electrical power supply: 230 V AC 50-60 Hz with earth.
- Rating: 30 W
- Pollution degree: 1.
- Overvoltage category: 2.
- Hygrometric and altitude operating conditions: RH: 90% / 2000 m.
- Waterproofing standard: IP 21.
- Electrical standard: CE compliant
- Fuse: F 500 mA AH (5 x 20 mm).

### **Hydraulic functions:**

- Stream self-cleaning prefilter with 2 filter ratings: 90 µm and 40 µm on stainless mesh.
- 10 µm BIRM cartridge filter® combined with extruded active carbon: treats chlorine, iron and manganese, and reduces nitrate content.
- 10 µm KDF® cartridge filter combined with extruded active carbon: treats heavy metals and micro-pollutants.
- Max. system pressure: 4 bars / 400 KPa.
- Water temperature: 5 to 30 °C.
- Filtered water delivery rate: max. 2 m<sup>3</sup>/h
- Max. hardness: up to 45 °f or 25 °dH.
- ¾" male inlet/outlet (or female using angle unions supplied).
- Integral air purge in head.
- Water purge for decompression.
- Dimensions cm (H x L x D): 59 x 59 x 17.
- Weight: 20 kg.

### **Accessories and consumables:**

- 10 µ 15" BIRM® cartridge filter with extruded active carbon (Cat. No.: Q511016001).
  - 10 µ 15" KDF® cartridge filter with extruded active carbon (Cat. No.: Q511015001).
  - 25 W UVc lamp (Cat. No.: Q512013001).
  - Four LR6 1.5-V batteries.
  - Quartz tube O-ring (Cat. No.: Q513010001).
  - Self-cleaning filter mesh + prefilter bowl seal (Cat. No.: Q511017001).
  - O-ring for filter bowl (Cat. No.: 527199).
- BIRM® is a registered trademark of the Clack Corporation. KDF® is a registered trademark of KDF Fluid Treatment.



## II - Description of Komeo

1. Inlet and outlet
2. Flow meter chamber - Anti-scaling - Power operated inlet valve.
3. Prefilter
4. Power operated valve
5. 15" filter bowls
6. Filter nut
7. UVC lamp connector
8. Anti-bacteria UVC chamber
9. Power cable
10. Pack of 4 batteries
11. Water purge
12. Touch control interface

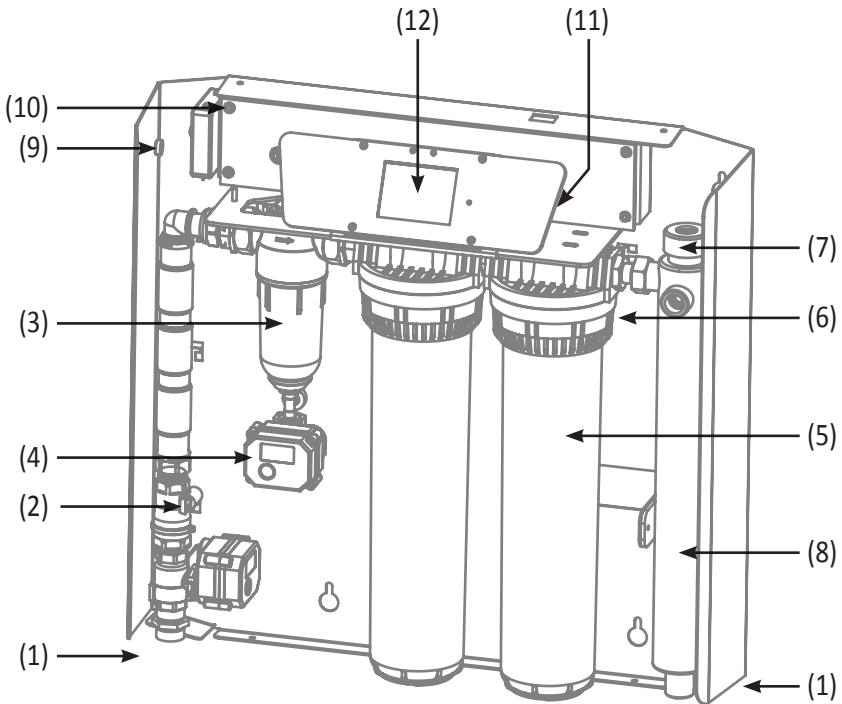

### III - Before installation

COMAP WT strongly recommends calling on a professional to install Komeo. Connection suggestions are offered, and the installation must be carried out according to good professional practice.

Remove the cover to unclip the washers that secure the device to the bottom of the box.

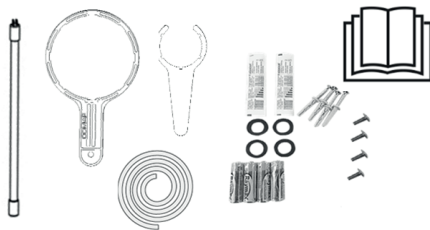
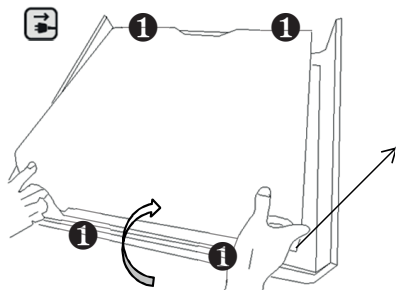

Check for presence of the accessory pouch containing:

The instruction manual and guarantee leaflet, four seals, four wall plugs, four LR6 1.5-V batteries, four screws and two TH hardness test strips,  $\varnothing 8$  pipe, one filter key and one prefilter key, a UVC lamp packaged in a protective tube (to be mounted and connected at the time of installation).

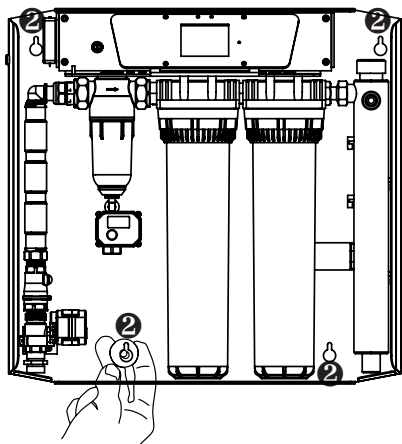

Remove the four fasteners **2** securing the Komeo base to the box, and withdraw Komeo.

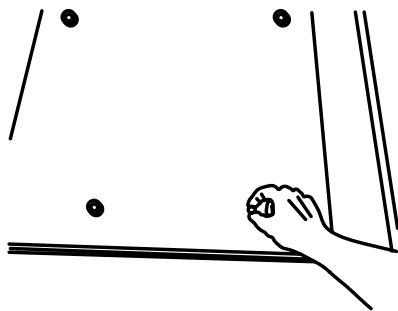

Take the spacers from the bottom of the box to mount the device on the wall.

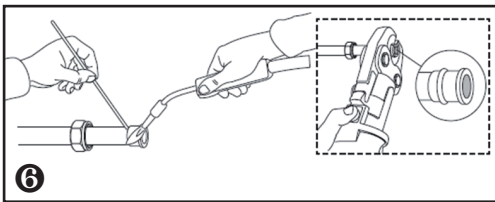
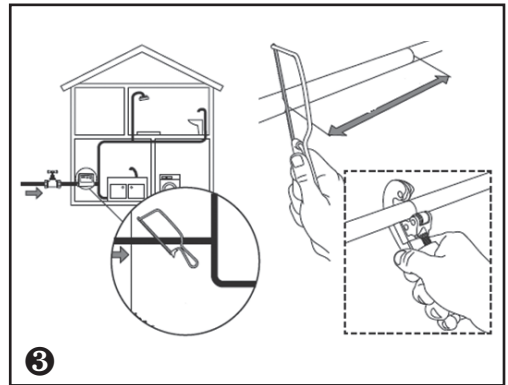
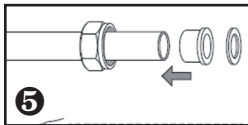
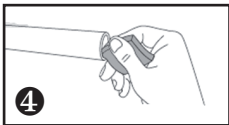
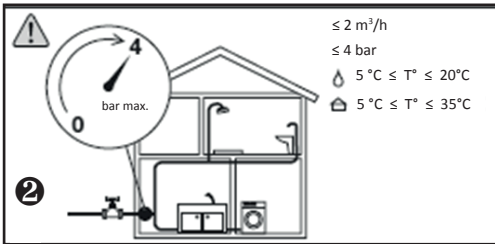
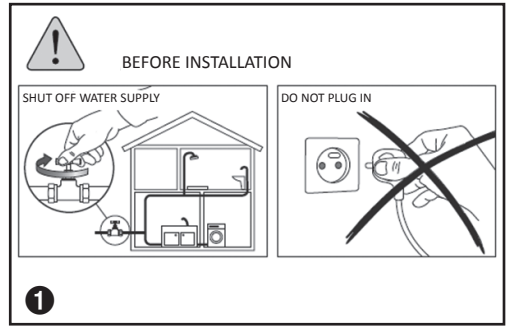
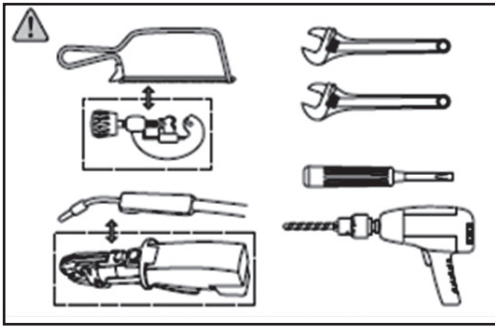

 Check for the presence of the following essential components upstream from the device: pressure reducer, standardised non-return valve, shutoff valve (upstream and downstream), as well as everything required to install a bypass on the device (strongly recommended).

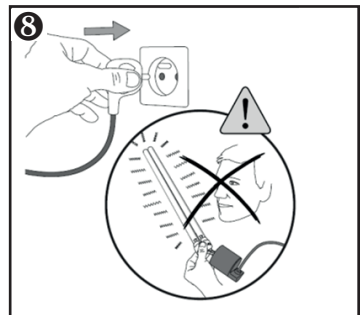
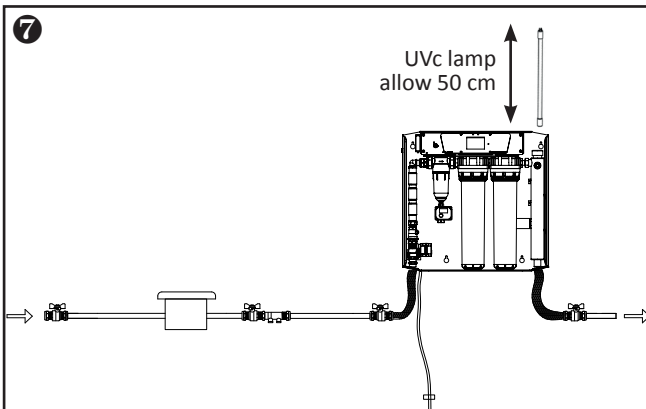

Check that the mounting points and the lines connecting them are level.

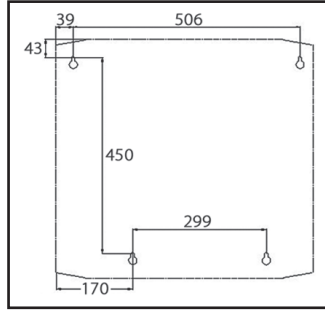
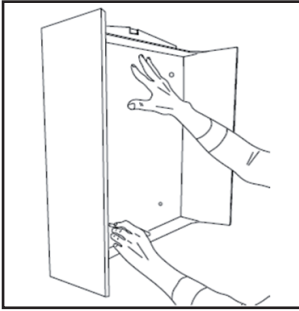

Use the box as a template and use a level to mark the mounting points for the unit. Use the unit mounting points on the box. Take care to place the box in the correct orientation.

Allow 50 cm clearance above the Komeo unit to remove the UVC lamp when replacing it.

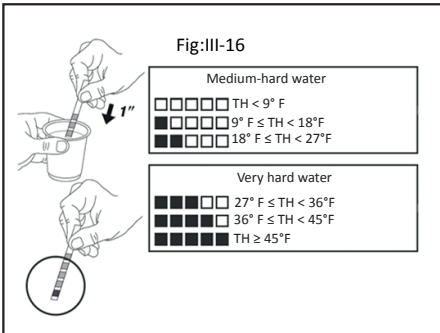

Measure the hardness of your water (TH) using the test strips supplied with the Komeo unit. To do this, immerse a test strip in a glass of tap water. Shake off the excess water, wait one minute, and then compare the colour to the scale shown above. This value will affect the anti-scaling power setting you apply to Komeo (to perform this measurement, read the instructions on the test strips and read the value in °f) or in °e).

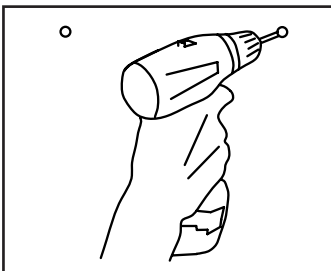
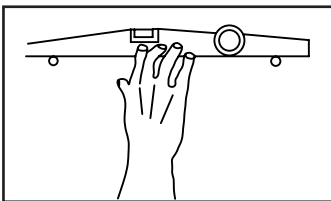

Drill using a 6-mm diameter drill bit (the correct diameter for the wall plugs supplied with the equipment). These wall plugs are for use in a dense material. You should check whether these wall plugs are appropriate for your substrate. If not, you must obtain appropriate wall plugs.

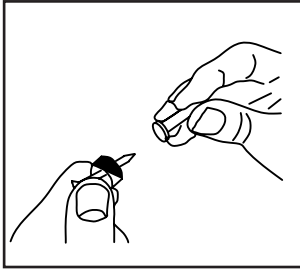

Remove the wall plugs from the screws and place the spacers between screw and wall plug. Choose appropriate wall plugs for the material and the weight of the machine (25 kg with water, with four mounting points).

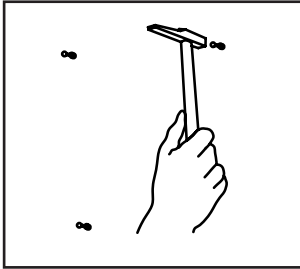

Insert the wall plugs in the holes, allowing the screw to protrude 5 mm beyond the spacer.

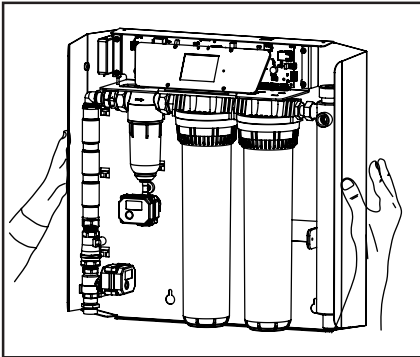

Place Komeo on its mounting points, check that the spacers are correctly positioned (between the machine and the wall), and tighten the four mounting screws.

# IV - Installing Komeo

## Hydraulic connection

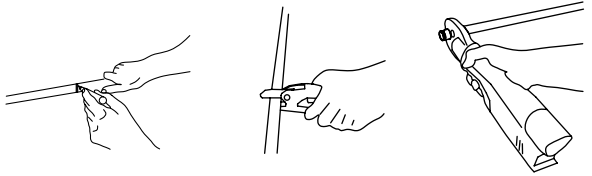
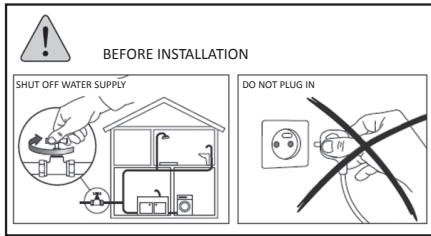

Check for the presence of a pressure reducer (not supplied) upstream from Komeo. If not, install one set to 4 bars max. The installation of a bypass (not supplied) and upstream isolating valves is recommended. The installation of a non-return valve is mandatory. Mark the position of the union on the pipe, and then cut the pipe. Shape the tube orifice. Position and crimp the union. Finally, tighten the hose onto the union.

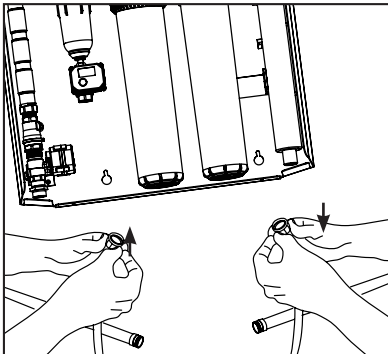

Position the hydraulic connection components you have chosen to connect Komeo to your installation.

Take care to observe the water flow direction (inlet to the left and outlet to the right).

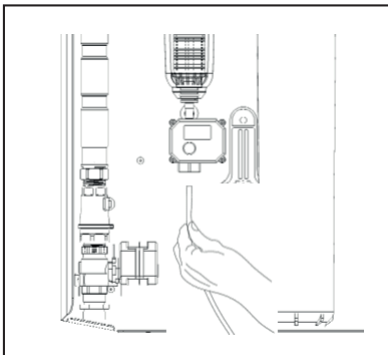

Position the drain tube by clipping it in the union.

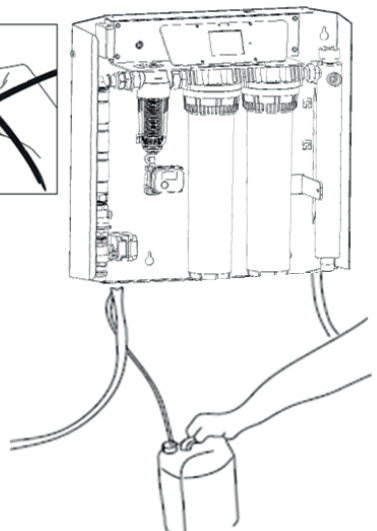
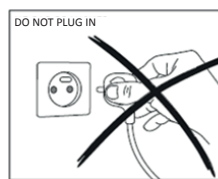

If there is no drain connection near the device, provide a 5-litre container for prefilter cleaning. For connection to the drain, provide a pipe connection (the self-cleaning of the prefilter is performed under pressure and this could cause the black pipe to come out of the drain connector).

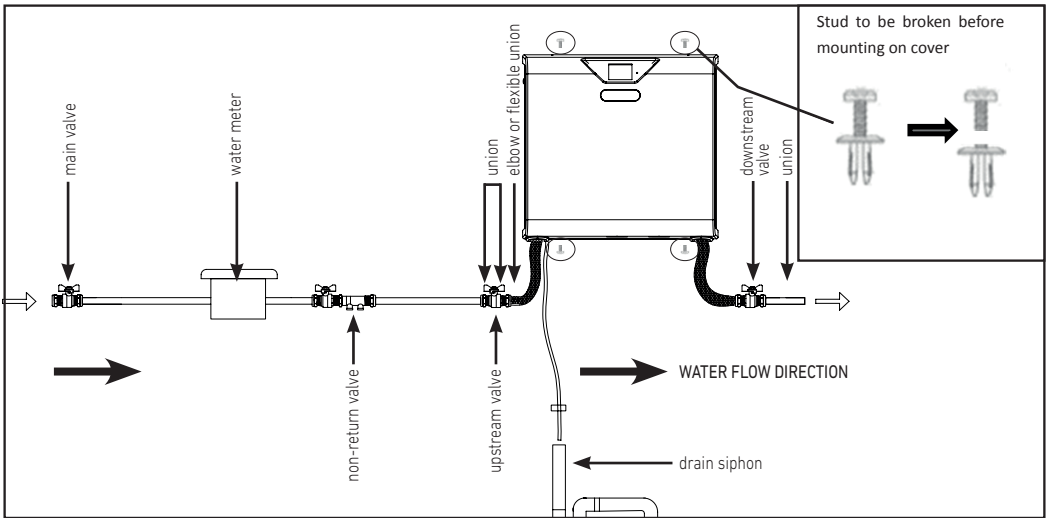

## Electrical connection

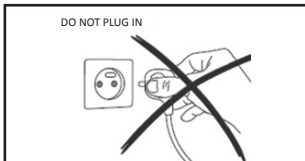

Do not connect the device to the electricity supply. Before applying power to the circuit, ensure that the switch of the back-up battery unit is set to ON.

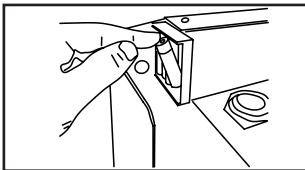

Insert the LR6 1.5-V batteries supplied as indicated in the photo, and observe the polarity of the box.

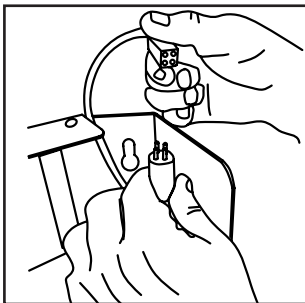

Position and connect the UVC lamp supplied in a protective shipping tube. Refer to the UVC lamp replacement maintenance procedure § VII – b) / fig: VII-4

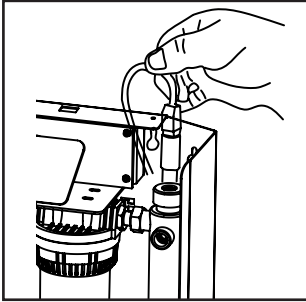
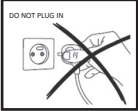

Once the hydraulic connection has been made, supply water by opening a valve upstream and a tap downstream to bleed out the air. Gradually close the tap as soon as water comes out of it. Check that Komeo and the connections are perfectly sealed.

Reposition the cover and secure using the four screws supplied.

Connect your device to the electrical system and follow the start-up guide to set the time, date, language, water hardness, mode of connection to the drain and mode of operation of the UVc lamp.

Note that Komeo is configured by default with the UVc lamp continuously on.

If necessary, run a system leak test in the maintenance menu (follow the instructions on the touch screen).

Hydraulic commissioning is now complete.

The treatment cartridges need to be rinsed. Run several litres through the system to rinse the new cartridges before drinking the water.

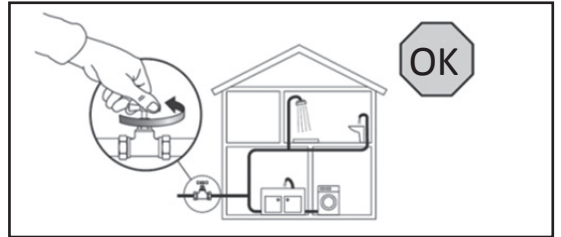
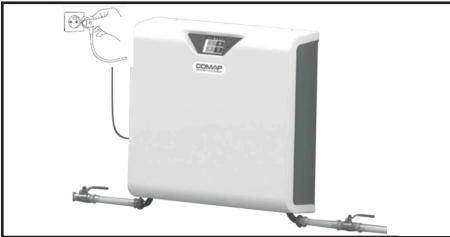



# V - Starting the machine



Do not connect the device to the electrical power supply until it is supplied with water and the protective cover on the front has been repositioned and secured using the four screws supplied. You must be equipped with the password for your **WiFi router**.

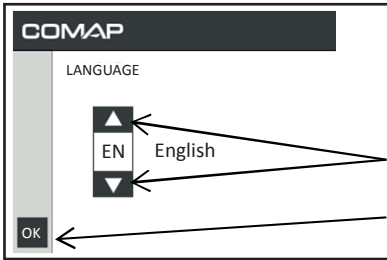

You will enter the start-up guide via the device's touch screen. Choose your language (French by default) or scroll through the languages via the up/down arrows, and then press the **OK** icon.

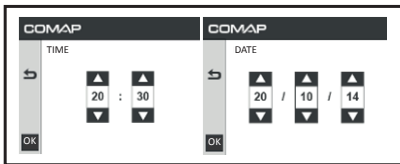

Set the date, time, UVc lamp operating mode, type of water circuit, type of self-cleaning prefilter connection (connected to the drain yes/no) and configure the water hardness to configure the electronic anti-scaling field after measuring the TH water hardness using the strips (see fig: III-16).

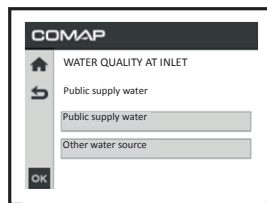
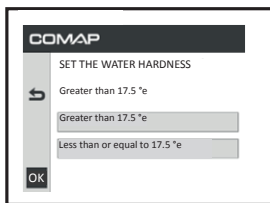
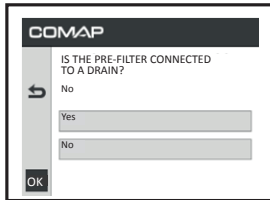

By default, Komeo is set to 1. Public supply water. This configuration can be modified. 1 Public supply water is only suitable for high-quality public supply water.

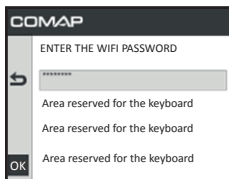
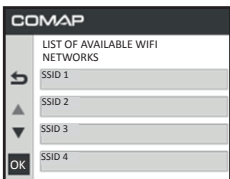

Select the name of your router from the list of WiFi networks (SSID networks) and then input your **WiFi** password (case-sensitive). Your router might require special configuration if connections to the WiFi network are disabled. Contact COMAP after-sales service in case of any connection difficulty.

# VI - Description of the touch screen

## a) Description of indicator lights

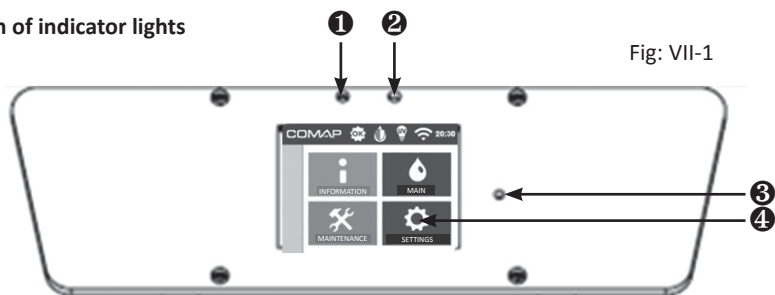
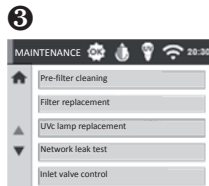
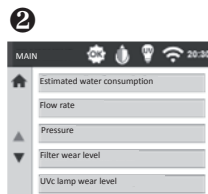
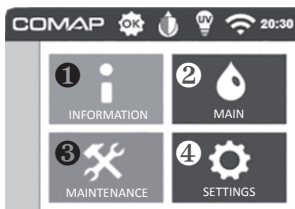

Fig: VII-1

- ① Inlet valve control pushbutton in offline mode (usable by the battery unit)
- ② Indication of valve position status during a power cut
- ③ System indication
- ④ Touch screen

## b) Description of menus



### ① INFORMATION menu

This menu tells you the Serial Number of your Komeo.

To return to the main menu, press the house icon in the upper left-hand corner. To go back, press the arrow under the house icon.

### ② GENERAL Menu

**Estimated water consumption:** tells you your water consumption per day, per week, and per month

**Flow rate:** tells you your flow rate

**Pressure:** tells you the instantaneous, average, and maximum pressure of the water system

**Filter status:** tells you the wear status of your cartridges

**UVC lamp status:** tells you the wear status of your UVC lamp

**Emergency unit:** tells you the wear status of your batteries

### ③ MAINTENANCE Menu

**Pre-filter cleaning:** starts the prefilter cleaning procedure

**Filter replacement:** starts the prefilter replacement procedure

**Replacing the UVC lamp:** starts the UVC lamp procedure

**Network leak test:** launches a test to detect the presence of leaks on the water system

**Inlet valve control:** opens or shuts off the water system

**Notifications and malfunctions:** displays alerts and system errors

**Alert history:** lets you view the history of alerts sent by Komeo

**Servicing/After-Sales Service** this menu is used for servicing by After-Sales Service

#### ④ SETTINGS Menu

**Language:** lets you set the language

**Date and time:** lets you configure the date and time

**UVc lamp programming:** lets you program up to three daily time slots during which the lamp goes into economy mode.

**Water hardness:** sets the water hardness. To measure the hardness of your water and choose the correct setting, use the test strip supplied in the Komeo box. Immerse it in a glass of tap water and shake off the excess water. Wait one minute, and then compare it to the scale given in this instruction manual, Part III - Before Installation.

According to the test result, set the electronic anti-scaling system to the correct position:

- Position 1 < 17.5 °e
- Position 2 between 17.5 °e and 35 °e

**Prefilter drain:** lets you drain the prefilter into the waste water system

**Water quality at inlet:** lets you set the quality of your inlet water:

- 1 Public supply water
- 2 Other water source

**WiFi connection:** lets you connect to your home WiFi network. Select your WiFi network and then enter your code to connect.

#### c) Downloading the remote control application

To install the unit's remote control application, visit the following links using your tablet or smartphone:

For Android: <https://play.google.com/store/apps/details?id=com.comap.watertreatment.komeo>

For Apple: <https://itunes.apple.com/app/proteo/id1120180106?mt=8>



#### d) Pairing the unit with the application

To pair the Komeo unit with the remote control application, apply the following procedure:

- ① Install the Android or iOS application on your smartphone or tablet.
- ② Connect your smartphone or tablet to the same WiFi network as the unit.
- ③ Go to the **Information** menu of the unit and enter the IP address from the **Information** menu of your smartphone or tablet to pair the two devices with each other.
- ④ Click OK and then wait for the two devices to be connected.

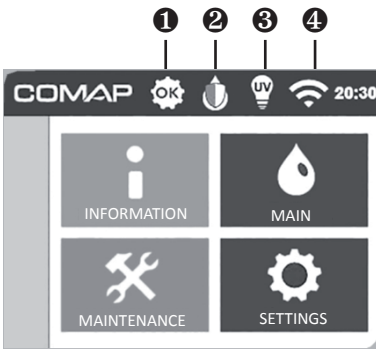

- 1 System in perfect operating condition.
- 2 UVC lamp management mode (configuring the time slots in economy mode).
- 3 Status of the UVC lamp (lamp ON).
- 4 WiFi status (WiFi enabled).

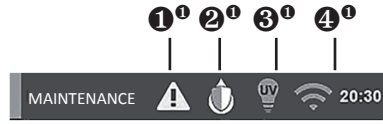

- 1° Alert status informing you of a minor error that does not affect the operation of the unit.
- 2° UVC lamp in safety mode.
- 3° Status of the UVC lamp (UVC lamp off).
- 4° WiFi off.

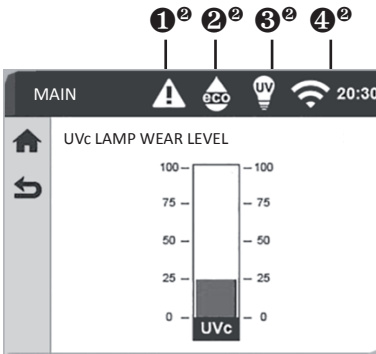

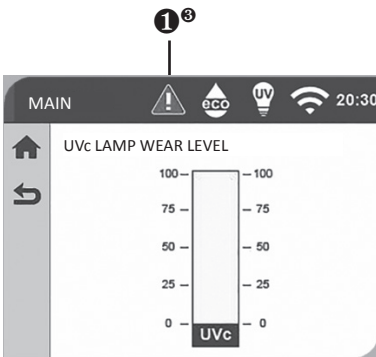

- 1° Alert status informing you of a minor error that does not affect the operation of the machine (yellow pictogram).
- 2° UVC lamp in economy mode.
- 3° UVC lamp ON.
- 4° WiFi ON.



- 1° Komeo malfunction alarm (red pictogram).  
When the red "Malfunction Alarm" triangle is displayed, go into the **Maintenance** menu and then choose "Alerts and malfunctions". This gives you the history of alerts and alarms. By clicking them, you can follow the troubleshooting instructions and reset them.

## b) Configuring the UVC lamp

 The UVC lamp is in economy mode: the lamp is in downgraded operation. After about an hour without water being drawn, the lamp shuts off. It automatically restarts as soon as water is drawn again.

 **Important: Economy mode is not recommended for any water not sourced from a good-quality system.** The UVC lamp is in safety mode: the lamp is in optimum operation. The lamp is programmed in this mode by default.

# VII - Maintenance / Troubleshooting

## a) Replacing the filters cartridge



Disconnect the power supply cable from the unit. The unit will restart in Maintenance Mode, powered by the battery unit. Next, remove the cover by removing the four screws. Select the **Maintenance** menu.

After reaching the desired consumables replacement program, follow the instructions on the touch screen.

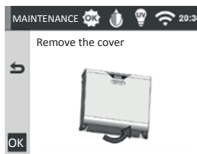
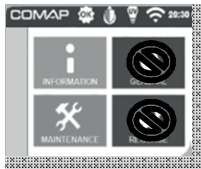

With regard to purging, use a container if the device is not connected to a waste water drain; to purge the prefilter, press the purge buttons together as shown on the touch screen in order to create an air inlet for the water to drain out. It is preferable to close the Komeo's outlet isolating valve to prevent the pipes located above Komeo from draining through the action of gravity.

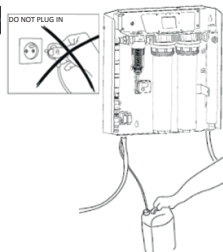
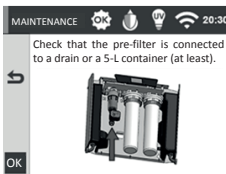

When the Komeo requests it, apply the instructions show on the screen. Using the blue filter key, loosen the filter bowl to replace the used BIRM® and KDF® cartridges. Position the new cartridges and confirm the change on the screen. Komeo then automatically shuts off the prefilter valve to avoid all risk of water splashing due to pressure in the system. Some water nevertheless remains in the filter bowls. Have a bucket available to place under the filter bowl.

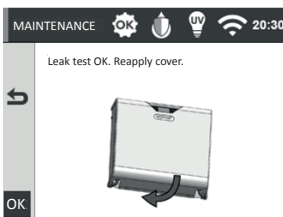
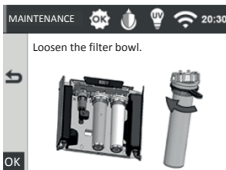

**Close the cover and tighten before reapplying power.**

## b) Replacing the UVc lamp

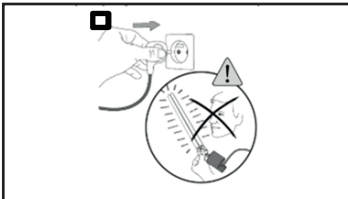
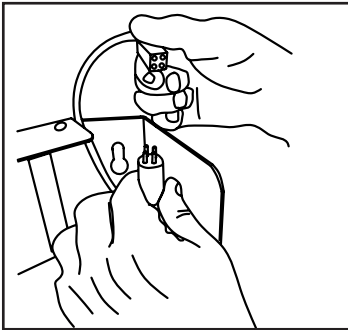
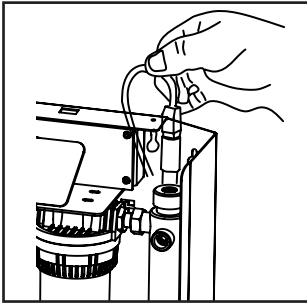
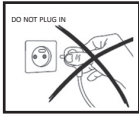

Disconnect the power supply cable from the unit. The unit will restart in Maintenance Mode, powered by the battery unit. Next, remove the cover by removing the four screws. Select the **Maintenance** menu.

When Komeo requests it, replace the UVc lamp by removing the lamp cap and taking care to disconnect it from the UVc lamp connector socket without pulling the cable or loosening the nut from the UVc chamber.

Replace the used lamp with a new lamp without releasing it in the quartz tube.

Connect the new lamp, reposition the lamp cap, and confirm the change on-screen. Follow the instructions on the screen.

Note that Cat. No. Q512013001 is the only UVc lamp model that is compatible with Komeo. The use of any other type of lamp could damage the device.



**Close the cover and tighten before reapplying power.**

## c) Automatic prefilter cleaning

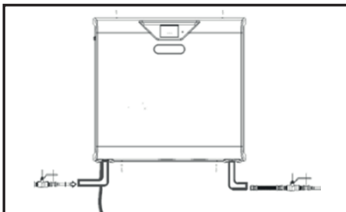

Disconnect the power supply cable from the unit. The unit will restart in Maintenance Mode, powered by the battery unit. Next, remove the cover by removing the four screws.

Select the **Maintenance** menu.

If the device is configured and connected to the drain system, automatic cleaning is autonomous.

If not: follow the Komeo instructions after preparing a 5-litre container. This container can be used to collect the suspended materials.



**When cleaning is complete: close the cover and tighten before reapplying power.**

### c) Manual prefilter cleaning

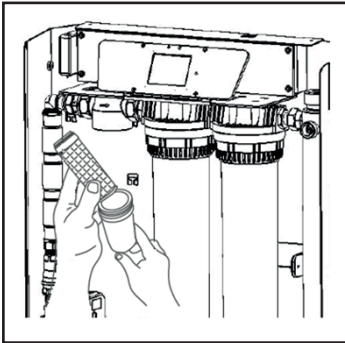
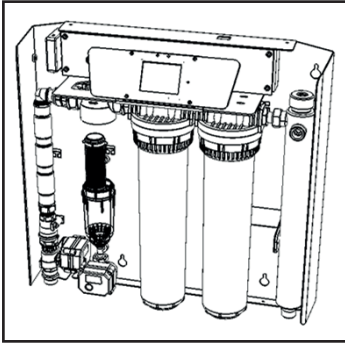

Disconnect the power supply cable from the unit. The unit will restart in Maintenance Mode, powered by the battery unit. Next, remove the cover by removing the four screws.

The prefilter can be cleaned or replaced manually by disconnecting the connectors from the pressure sensor and the power operated drain valve. Loosen the filter bowl using the key.

When the cartridge becomes accessible, rinse it and clean it using a brush. Replacement every two years is recommended.



**Close the cover and tighten before reapplying power.**

### e) Replacing the fuse



Fuse holder

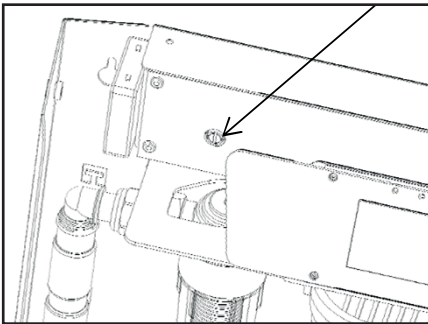

Disconnect the power supply cable from the unit. The unit will restart in Maintenance Mode, powered by the battery unit. Next, remove the cover by removing the four screws.

This operation must be performed by a professional. Call COMAP after-sales service if necessary.

Using a flat screwdriver, press and turn ¼-turn anticlockwise to open the plug of the fuse F 500mA AH.

## VIII - Troubleshooting guide

### a) Guide to errors

Nature of error	Causes	Solutions
Flashing red LEDs Items 2&3 Fig. VII-1 + touch screen off	Power cut + Batteries out of order Fuse out of order + batteries out of order	Disconnect the power supply + replace the LR6 1.5-V batteries + reboot. If the unit does not start up, a certified technician must replace the 5 x 20 mm F 500 mA AH fuse according to the procedure, or call COMAP after-sales service
Flashing red LEDs Item 3 Fig. VII-1	General error	Press the touch screen to reactivate the screen and follow the instructions in the Maintenance menu: "Notifications and mal-functions"
UVc lamp NOK	Worn lamp > 12,000 H Lamp blown Ballast inoperative	Replace the UVc lamp Replace the UVc lamp Contact COMAP after-sales service
Spent cartridges Clogged prefilter	Life > 1 year Clogging detected by deltaP Pressure sensor problem Pressure sensor calibration	Replace the cartridge Clean the prefilter
Spent batteries	Life > 1 year Power cut > a few days	Replace the LR6 1.5 V batteries
Dangerous pressure notification	Pressure above 4 bars Water hammer	Install or replace a pressure reducer Install a water hammer prevention device Contact COMAP after-sales service
Network leak notification	Volume of water that has flowed without interruption > 500 L	Check the water system (flush or tap left running or obvious or hidden leak). Manually open the inlet valve if no leak is found, or call COMAP after-sales service.
Screen frozen, touch screen inoperative, bug	Firmware inoperative	Program updated via USB key via a qualified technician. Contact COMAP after-sales service
Water leak in the machine	Badly tightened unions, damaged seals, old seals, crack following an overpressure, shocks, etc.	Close the device's inlet valve, set it to bypass (shunt), and contact COMAP after-sales service.



## b) What to do in case of a power cut



Disconnect the power supply cable from the unit. The unit will restart in Maintenance Mode, powered by the battery unit. Next, remove the cover by removing the four screws.

If the electrical power supply is absent, the anti-scaling treatment and disinfection treatment (UVC lamp) functions will not be provided. The device's power operated inlet valve will be closed via an interlock via the battery unit. The power operated valve can be opened to obtain untreated water (the 90µm/40µm filtration and anti-drop, micropollutant treatments are still active) by actuating the pushbutton (Fig. VII-1) using a fine screwdriver. If the power cut continues for a long time, you can switch the battery unit OFF to preserve battery life. Note: this operation will prevent the power-operated inlet valve from being operated again (closed or opened) without mains power being restored.

## c) Other maintenance operations



Disconnect the device's power supply cable before any maintenance operation takes place. The unit will restart in Maintenance Mode, powered by the battery unit. Next, remove the cover by removing the four screws.

- Clean quartz tube and replace O-rings and quartz tube bearing seals. We recommend you call on a certified technician or call COMAP after-sales service to find out the details and procedures of these preventive maintenance actions.
- Replacing the pressure sensors: the inlet and outlet pressure sensors are intended to be recalibrated via the maintenance menu on the touch screen. Contact COMAP after-sales service to obtain the recalibration procedure or to replace any defective sensors.
- Replacing the power operated valves: these valves are designed to perform many opening and closing cycles. Contact COMAP after-sales service in case of any defect.
- Replacing the filter bowl O-rings: the filter bowl seals are wear parts that can deteriorate over time and after repeated handling. Plan for their preventive or corrective replacement in case of incorrect placement in the filter bowl groove (pinching).
- Prefilter mesh: self-cleaning. Can also be deep-cleaned by removing the bowl from the prefilter and using a brush. Contact COMAP after-sales service to obtain a procedure.
- Seals: the purpose of the flat O-rings is to seal the device. They should be replaced preventively within five years because of ageing.
- Flow meter: the turbine must be cleaned preventively, or correctively in the event of a clog. Contact COMAP after-sales service to find out the procedure.
- Electronic board: to be replaced only in the event of failure. Remember to disconnect it in the event of a storm or voltage surge. Contact COMAP after-sales service in case of any malfunction.
- Touch screen: the touch screen must be cleaned once a year using a product suitable for touch screens. Do not use water, detergents, or any other product not described as being suitable for cleaning touch screens. Do not carry out this operation whilst the device is in operation.

#### d) What to do in case of a long absence



Disconnect the device's power supply cable before any maintenance operation takes place. The unit will restart in Maintenance Mode, powered by the battery unit. Next, remove the cover by removing the four screws.



- Set the battery unit switch to OFF.
- Remove the active carbon + BIRM and active carbon + KDF cartridges and store them in a clean, dry location protected from sunlight.
- Return to service is performed in reverse order from the wintering procedure (replace cartridges, set the battery unit to ON, reinstall the cover, and then plug in the device).
- Allow a few litres of water to flow out before you drink any.

These instructions can change at any time. Software updates can also be applied (patches or the addition of new functionality).

Follow the updates on the website: **[www.comapwt.com](http://www.comapwt.com)**

Download the Komeo remote control application to keep up to date with events in your system, your water consumption, and the status of your consumables.



## COMAP Water Treatment

ZA Les petits champs - 26120 MONTÉLIER - FRANCE / E-mail : [comapwt@comap.eu](mailto:comapwt@comap.eu)

Website : [www.comapwt.com](http://www.comapwt.com) / Customer service:: Tel. 00 33 4 75 85 28 11 - Fax 00 33 4 75 85 42 62

COMAP SA - 16, avenue Paul Santy - BP 8211 - 69355 LYON Cedex 08

[www.comap-group.com](http://www.comap-group.com)